

ITEM	PETERBILT PARTS	GRAMAG SERVICE KIT NO.
1	TRIM - PETERBILT	SEE DRAWING PAC-SP12004
2	FOAM - PETERBILT BACK	PAC-SP11329
3	FOAM - PETERBILT BACK VENT	PAC-SP11330
4	FOAM - PETERBILT CUSHION	PAC-SP11249
5	FOAM - PETERBILT CUSHION VENT	PAC-SP11331
6	BACKFRAME - PETERBILT HIGHBACK	PAC-SP12127
23	HEATERS-PETERBILT BACK & CUSH	PAC-SP11304
24	VENT/HEAT PETERBILT BACK & CUSH	PAC-SP11339
33	ARMREST ASM LH PETERBILT	SEE DRAWING PAC-SP11814
34	ARMREST ASM RH PETERBILT	SEE DRAWING PAC-SP11815
35	STOWABLE ARMREST RH PETERBILT	SEE DRAWING PAC-SP11816

ITEM	COMMON PARTS	GRAMAG SERVICE KIT NO.
7	FULL RECLINE AND PIVOT BRKT	PAC-SP11255
8	HANDLE ASM - CUSHION	PAC-SP11257
9	SIDE SHIELD - LH GT703	PAC-SP11334
10	HANDLE ASM - RECLINE	PAC-SP11259
11	SWITCH - LUMBAR TRIPLE GT703	PAC-SP11335
12	SIDE SHIELD - RH	PAC-SP11262
13	SIDE SHIELD - RH CLIMATE	PAC-SP11263
14	SKIRT	PAC-SP11264
15	TRACK AND HANDLE ASM	PAC-SP11265
16	2 PIECE RISER 2.1M SERVICE KIT	PAC-SP12002
17	BUCKLE, WEBBED NO WIRE	PAC-SP11933
18	BUCKLE, WEBBED WITH WIRE	PAC-SP11932
19	SWITCH - HEAT	PAC-SP11294
20	SWITCH - HEAT & VENT	PAC-SP11274
21	LUMBAR BAG (DOUBLE) AND HOSES	PAC-SP11994
22	BOLSTER BAG AND HOSES	PAC-SP11340
25	OCC SENSOR	PAC-SP11272
26	WIRE HARNESS (HEAT) NGP	PAC-SP11273
27	WIRE HARNESS (OCC SENSOR & BUCKLE) NGP	PAC-SP11305
28	WIRE HARNESS (OCC SENSOR, BUCKLE, HEAT) NGP	PAC-SP11306
29	WIRE HARNESS (HEAT & VENT) NGP GT703	PAC-SP11341
30	WIRE HARNESS (OCC SENSOR, BUCKLE, HEAT & VENT) NGP GT703	PAC-SP11342
31	SWIVEL & CARPET	PAC-SP11300
32	CARPET	PAC-SP11301
36	CUSHION PAN ASM	CONTACT GRAMAG
38	AIR SEAT HOSES AND CONNECTORS	PAC-SP11995
40	DAMPENER, VARIABLE	PAC-SP11878
41	SWITCH ASM - PREMIUM SUSPENSION	PAC-SP11876
42	SUSPENSION AIR BLADDER	PAC-SP11877
43	SUSPENSION LEVEL CONTROL	PAC-SP11817
44	SEAT TILT MECHANISM	PAC-SP11880
46	STOWABLE ARM REST BRACKET	PAC-SP11869
47	HEIGHT ADJUSTMENT CABLE SERVICE KIT	PAC-SP11873
48	QUICK DOWN CABLE SERVICE KIT	PAC-SP11874
49	DAMPENER CABLE SERVICE KIT	PAC-SP11875
50	DAMPENER ADJUSTMENT HANDLE SERVICE KIT	PAC-SP11882
51	FORE AND AFT ISOLATOR SERVICE KIT	PAC-SP11883
52	FORE AND AFT ISOLATOR CABLE SERVICE KIT	PAC-SP11884
53	FORE AND AFT ISOLATOR HANDLE SERVICE KIT	PAC-SP11885
54	WIRE HARNESS(WIRED BUCKLE ONLY)NGP DRIVER SERVICE KIT	PAC-SP11988
55	WIRE HARNESS(BUCKLE,HEAT)NGP DRIVER SERVICE KIT	PAC-SP11989
56	WIRE HARNESS(BUCKLE,HEAT+CLIMATE)NGP DRIVER SERVICE KIT	PAC-SP11990
57	ARMREST LOCKING BOLT AND CAP SERVICE KIT	PAC-SP11996
58	CUSHION PAN GUIDE SERVICE KIT	PAC-SP12058

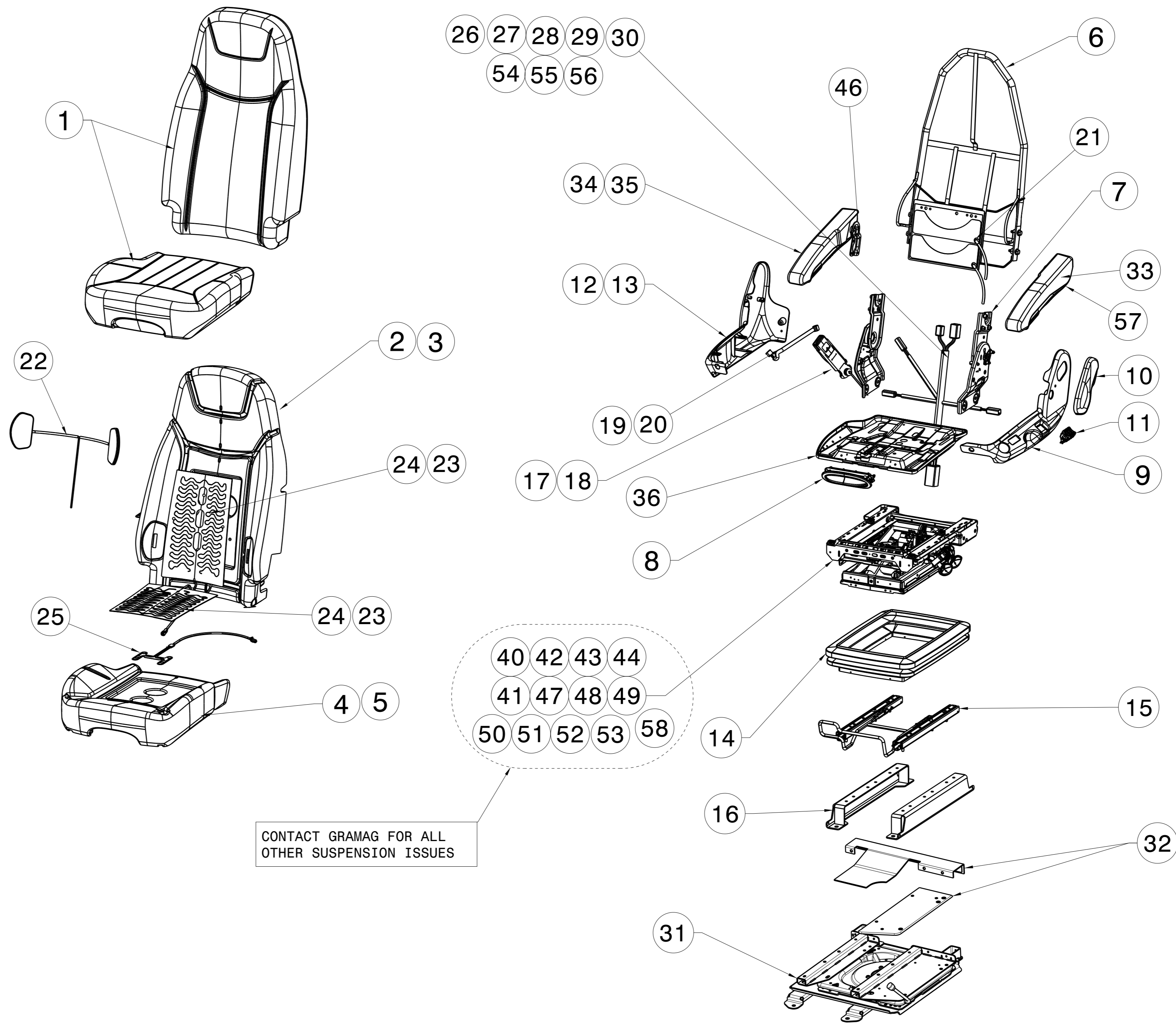

CONTACT GRAMAG FOR ALL OTHER SUSPENSION ISSUES

APPLIES TO PETERBILT PART NO'S:

- S78-1084-00000000
- S78-1109-00000000
- S78-1111-00000000
- S78-1119-00000000
- S78-6059-00000000
- S78-1127-00000000
- S78-1177-00000000

REV	DATE	BY	DESCRIPTION	DATE	DRW	CHK	APR
7477	09	DA	ADDED PAC-SP11883	17JUL18	BT	LF	**
7465	DA	DA	ADDED S78-1177-00000000; REMOVED PAC-SP11252, ADDED PAC-SP12127; REMOVED PAC-SP11794	16APR18	BT	LF	**
7422	CC	CC	ADDED PAC-SP12058	31MAR17	BT	**	**
7414	CB	CB	REMOVED PAC-SP11883	06JAN17	BT	**	**
7402	CA	CA	REMOVED PAC-SP11266, ADDED PAC-SP12002	19OCT16	BT	**	**
7403	CA	CA	REMOVED PAC-SP11302, ADDED PAC-SP12004	19OCT16	BT	**	**
7395	BC	BC	ADDED KIT PAC-SP11996	19OCT16	BT	**	**
7392	BB	BB	REMOVED PAC-SP11336 AND PAC-SP11482; ADDED PAC-SP11994 AND PAC-SP11995; ADDED NOTE REGARDING SUSPENSIONS	06JUL16	BT	**	**
7394	BB	BB	ADDED KITS PAC-SP11988, PAC-SP11989, PAC-SP11990	02MAY16	BT	**	**
7378	BA	BA	RELEASED WEBBED BUCKLE; PAC-SP11932 WAS SP11597, PAC-SP11933 WAS PAC-SP11596 REPLACED UPPER PIVOT BACK WITH HIGHBACK FRAME; PAC-SP11252 WAS PAC-SP11333	30JUL15	GAS	**	**
7328, 7332	AJ	AJ	UPDATED KITS	06AP15	GAS	**	**
7311	AH	AH	ITEMS 44 & 45 ADDED	30SE14	GSS	**	**
7310	AG	AG	ITEMS 36 & 37- "CONTACT GRAMAG" WAS "NOT SERVICEABLE"	12SE14	GAS	**	**
7277	AF	AF	ADDED SUSPENSION LEVEL CONTROL KIT, ITEM 43	20FEB14	INT	**	**
7261	AE	AE	REPLACED ARMREST KITS WITH LONGER ARMREST; ADDED PN S78-1127	28JAN14	INT	**	**
7270	AD	AD	ADDED SUSPENSION COMPONENT KITS ITEMS 40-42	13JAN14	INT	**	**
7268	AC	AC	ADDED PN S78-6059 FOR PETERBILT 75TH ANNIVERSARY	11DEC13	INT	**	**
7260	AB	AB	ADDED KIT FOR SWIVEL WARNING LABEL ITEM 39	21NOV13	INT	**	**
7262	AA	AA	RELEASED FOR SERVICE	25OCT13	INT	**	**

UNLESS OTHERWISE SPECIFIED DRAWING TOLERANCES ARE:

L INEAR	ANGULAR
ONE PLACE ± X.X	ONE PLACE ± X.X °
TWO PLACE ± X.XX	TWO PLACE ± X.XX °

— DO NOT SCALE THIS DRAWING —

FILE NO. SEE PART BLOCK

COMPUTER GENERATED GRAPHICS

DATE: 04APR12

SCALE: X

NAME: NGP GT703 SEAT ASM SERVICE KIT

NO: PAC-SP11766-DWG

PAC-SP11766-DWG UNCONTROLLED