

ITEM	PART NO.	PART NAME	QTY
1	PAC-10805	FOAM ASM - KENWORTH GT703 VENT	1
2	PAC-11087	FOAM - CYLINDER FILLER	2
3	PAC-10966	FOAM - FILLER RECTANGLE	1
4		BOX	1

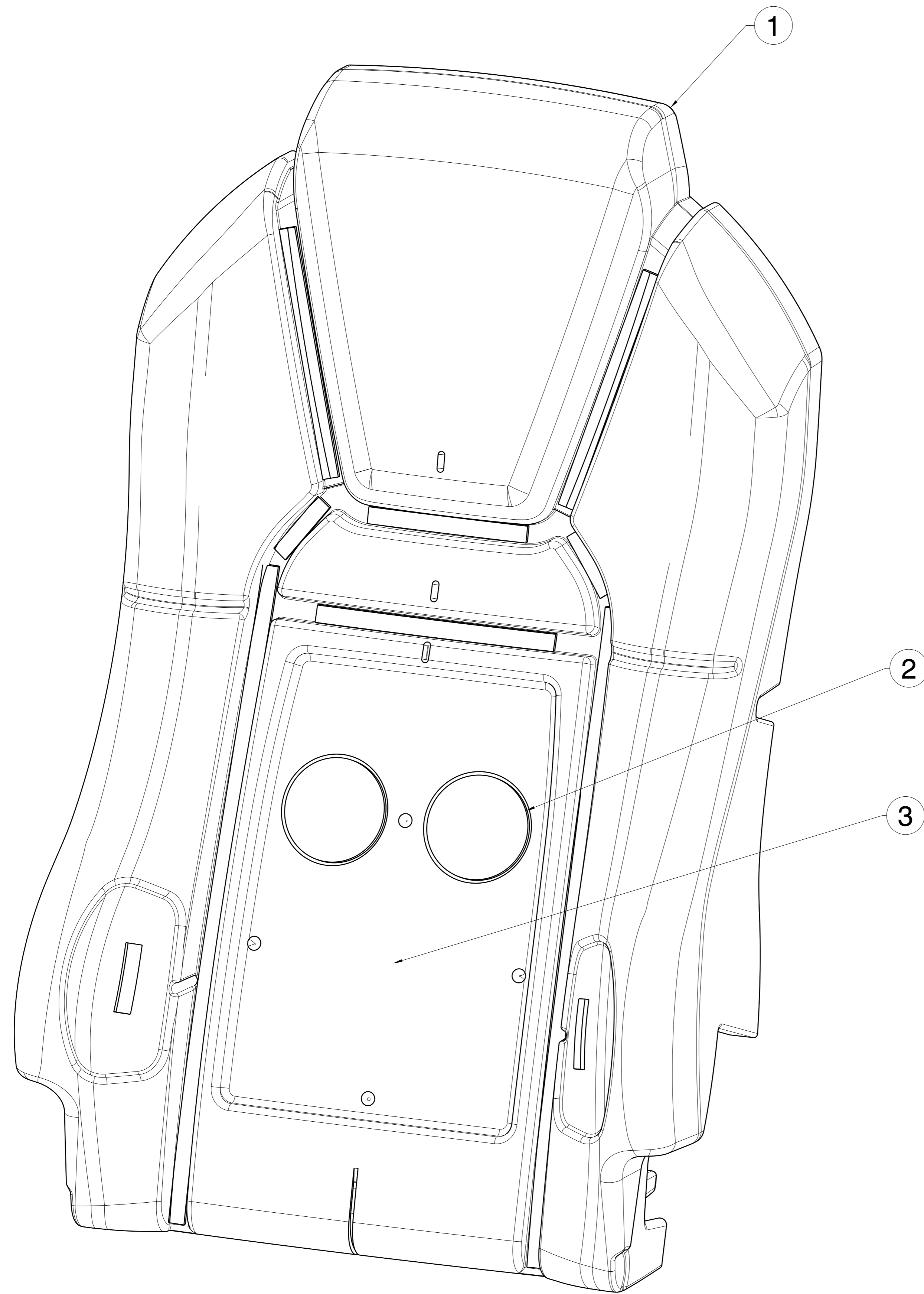

7216	AA	RELEASED FOR SERVICE	26JUL12	INT	**	**
CHG NO.	LET	REVISION	DATE	DRW	CK	APR
UNLESS OTHERWISE SPECIFIED DRAWING TOLERANCES ARE			DIMENSIONING & TOLERANCING PER ASME Y14.5 M-1994			
LINEAR		ANGULAR	LAST VIEW			
ONE PLACE	± X.X	ONE PLACE	LAST SECT			
TWO PLACE	± X.XX	TWO PLACE	3RD ANGLE PROJECTION			
± X.XX		± X.XX °	COMPUTER GENERATED GRAPHICS			
± X.XX		± X.XX °	FILE NO. SEE PART BLOCK			
- DO NOT SCALE THIS DRAWING -			THIS DRAWING IS COPYRIGHTED AND REMAINS THE EXCLUSIVE PROPERTY OF GRAMMAG INC. UNAUTHORIZED COPYING, REPRODUCTION OR OTHER USE IS PROHIBITED AND WILL BE PROSECUTED.			
DRAWN BY	DATE	CHECKED	APPROVED	UNLESS OTHERWISE SPECIFIED DIMENSIONS ARE IN MM		
INTENT	23APR12	**	**	SCALE		
MATERIAL			GRAMMAG		1:2	
NAME			truck interior systems		NO	
FOAM - KENWORTH GT703 HIGH BACK SERVICE KIT			PAC-SP11326-DWG			

PAC-SP11326-DWG  
UNCONTROLLED